

RFX400 Top Rail for Level Applications

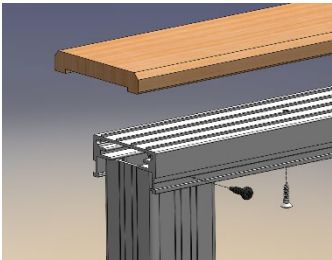

RFX400 Top Rail

Allows for a wood / composite cap to be attached to the RailFX rail system. Cap can be screwed directly to top rail or dadoed out.



Attaching to End Post

Top rail slides over top of post and attaches with 2 each screws. 1 screw on each side.

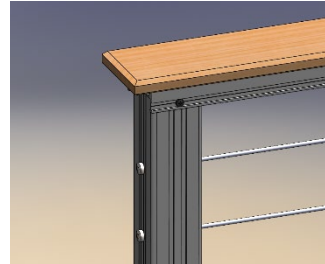

Attaching to End Post

Wood / Composite cap attaches to RFX400 top rail by screws from the bottom side.

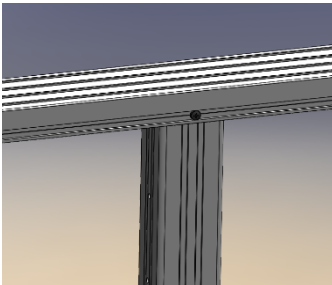

Attaching to Intermediate Post

Rail slides over top of post and attaches with 2 each screws. 1 screw on each side.

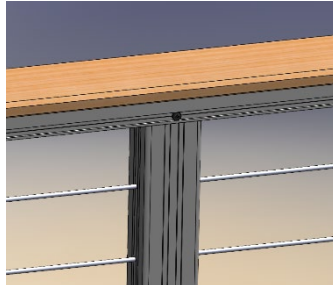

Attaching to Intermediate Post

Wood / Composite cap attaches to RFX400 top rail by screws from the bottom side.

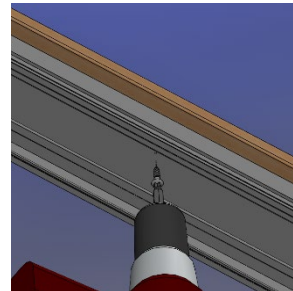

Screwing from Bottom Side

Wood / Composite cap attaches to RFX400 top rail by customer provided screws from the bottom side. Attach cap before installing flat infill.

RFX400 Top Rail for Level Applications

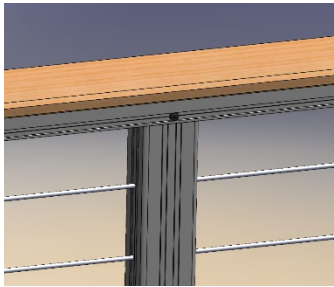

Straight Splice Option 1

Both top rails slide over top of post and attach with screws. 1 screw on each side. (Total of 4 each screws.)

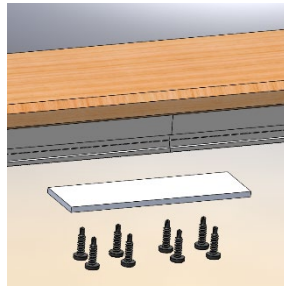

Straight Splice Option 2

Splice must be secured into place with 8 each screws from underside. Splice is made from a cut piece of Internal Post Stiffener.

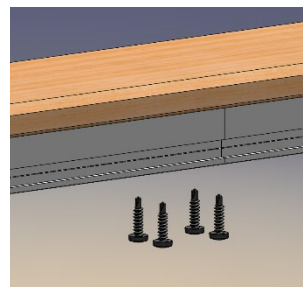

Straight Splice Option 3

Use wood / Composite as splice to connect rails together where RFX400 rails meet between posts.

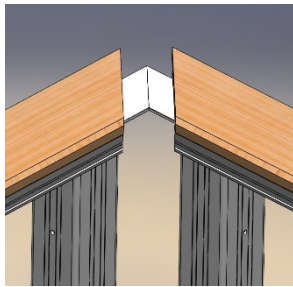

Angle Splice

Splice must be secured into place with 8 each screws from underside. (Top rail must be mitered.)

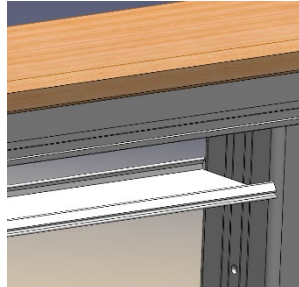

RFX400 – Flat Infill

Cut flat infill to length and snap into bottom side of top rail. **Install prior to tensioning the cables.**



RFX400 Top Rail for Level Applications

Special Notes:

- RFX400 top rail is designed to allow for the attachment of a wood or composite cap rail.
- Cap rail **MUST add 1"** or more to overall rail height to reach the required rail heights for both 36" and 42" rails.
- A scarf joint should be used to allow for expansion and contraction of cap rail.
- Painting the ends of railings that have been cut will help to prevent corrosion.

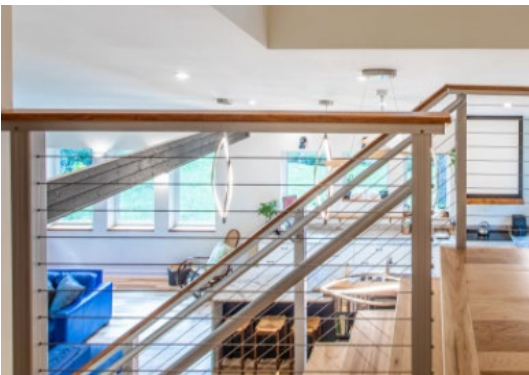

RFX 400 Top Rail with Composite Cap Rail

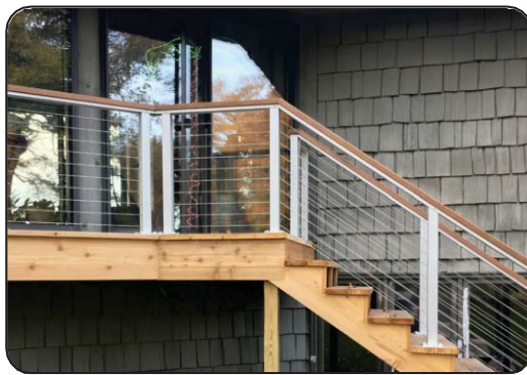

RFX 400 Top Rail with Wood Cap Rail