



Arndt & Herman aluminum columns are extremely durable, load bearing columns that are lightweight and easy to install. They maintain their beauty much longer than wood columns and are available in diameters from 5 to 36 inches wide.

## ROUND



Corinthian Capital    Doric Capital    Standard Capital  
Scamozzi Capital    Doric Base    Standard Base

## SQUARE

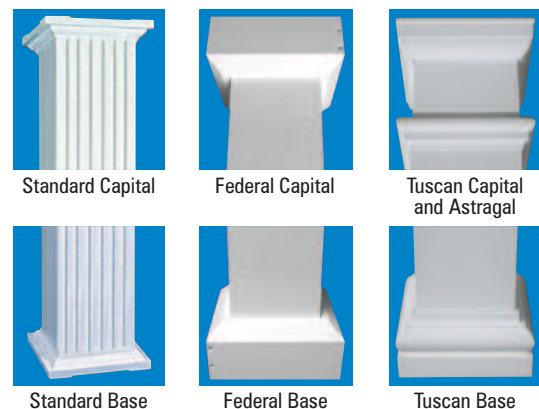

Standard Capital    Federal Capital    Tuscan Capital and Astragal  
Standard Base    Federal Base    Tuscan Base



Architectural Capitals    Architectural Bases

### Six available powder coat finishes.

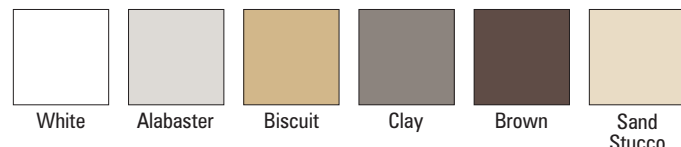

Factory primed columns can be special ordered. Check color samples at dealer.

### Round Column Dimensions

Nominal Column Diameters	Standard Cap/Base Dimensions			No. Staves	Standard Lengths	Maximum Load Lbs
	A	B	C			
5" Round	5"	7"	1-7/8"	1	8'	16,000
6" Round	5-3/4"	7-5/8"	1-5/16"	3	8',9',10',12'	16,000
8" Round	7-3/4"	9-3/4"	2-1/16"	3	8',9',10',12',16'	28,000
10" Round	9-1/2"	11-3/4"	2-1/2"	4	8',9',10',12',16',18'	30,000
12" Round	11-1/2"	14-1/4"	3"	5	8',10',12',16',18',20'	30,000
15" Round	14-1/4"	17-7/8"	3-3/4"	6	12',16',18',20',24'	31,000
18" Round	17-1/4"	20-13/16"	4-1/2"	7	16',18',20',24'	31,000
24" Round	23-5/8"	28-1/2"	6-1/4"	10	18',20',24',30'	31,000
36" Round	Available with Roman Doric Capitals and Bases			Ask for architect specifications		

### Square Column Dimensions

3" T-F	3"	5-3/8"	1-7/8"	1	8',10'	10,000
4" T-F	4"	6-5/8"	1-13/16"	2	8',10'	15,000
6" T-P-F	5-1/2"	8-3/8"	1-15/16"	4	8',9',10',12'	T17,000 PF30,000
8" T-P-F	7-1/2"	10-1/2"	1-15/16"	4	8',9',10',12',16',18'	T17,000 PF35,000
10" T-P-F	9-1/2"	13-3/8"	2-9/16"	4	8',9',10',12',16',18'	39,000
12" T-P	11-1/2"	7-1/2"	3-9/16"	4	10',12',16',18',20'	39,000

T= Traditional, P= Plantation, F=Federal

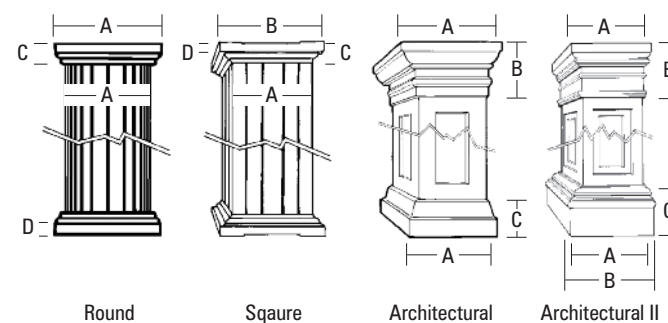

Round    Square    Architectural    Architectural II

### Architectural Square Cap & Base Dimensions

Nominal Column Diameters	Cap Dimensions		Base Dimensions		
	A	B	A	B	C
6" Architectural	9-1/8"	6-3/8"	7-5/8"		4"
8" Architectural	11-1/4"	6-3/8"	9-3/8"		4"
10" Architectural	13-3/8"	6-3/8"	11-1/2"		4"
12" Architectural	15-1/8"	6-3/8"	13-1/2"		4"
10" Architectural II	13-1/4"	10"	14-5/8"	16"	10"
12" Architectural II	16-3/4"	10"	17"	18-3/8"	10"

### Federal and Tuscan Cap & Base Dimensions

Size	Federal		Tuscan		
	Capital & Base	Size	Capital	Base	
6"	4" x 89/16" SQ	6"	2-1/4" x 7-3/4" SQ	4" x 7-1/2" SQ	
8"	4" x 10-1/2" SQ	8"	2-1/4" x 9-3/4" SQ	4" x 9-1/2" SQ	
10"	4" x 12-5/8" SQ	10"	2-1/4" x 11-3/4" SQ	4" x 11-3/4" SQ	
12"	4" x 14-5/8" SQ	12"	2-1/4" x 13-3/4" SQ	4" x 13-1/2" SQ	

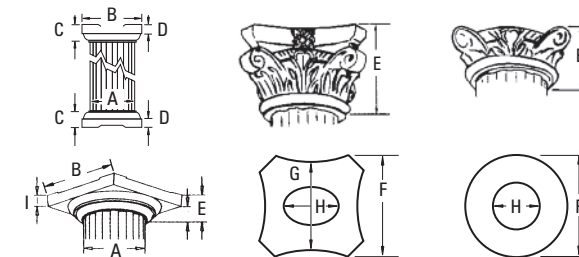

### Round Decorative Capitals

DIA.	Corinthian				
	A	E	F	G	H
8"	7-3/4"	10-1/2"	16-3/8"	15-1/16"	6"
10"	9-1/2"	10-1/2"	16-3/8"	15-1/16"	6"
12"	11-1/2"	12"	21-1/8"	18"	8"
15"	14-1/2"	14-3/4"	24-5/16"	21-1/2"	12"
18"	17-1/4"	19-1/4"	30-1/2"	27-9/16"	12"
24"	23-5/8"	26"	42-1/8"	34-1/4"	18"

### Scamozzi

DIA.	Scamozzi				
	A	E	F	G	H
8"	7-3/4"	5"	14-1/8"	N/A	7-3/8"
10"	9-1/2"	5"	14-1/8"	N/A	7-3/8"
12"	11-1/2"	6"	16-3/4"	N/A	6"
15"	14-1/2"	17-1/8"	20-7/18"	N/A	9-3/4"
18"	17-1/4"	12-5/16"	30-1/4"	26"	12-7/16"
24"	23-5/8"	18-1/4"	41-3/4"	34"	18"

### Doric

DIA.	Doric				
	A	B	E	I	J
8"	7-3/4"	5"	3-11/16"	1-7/16"	2-1/4"
10"	9-1/2"	14-1/4"	4-1/4"	1-1/2"	2-15/16"
12"	11-1/2"	17-1/4"	5"	1-3/4"	3-1/4"
15"	14-1/2"	20-1/4"	5-5/8"	2-1/8"	3-1/2"
18"	17-1/4"	24-5/8"	7-7/8"	3-1/4"	4-9/16"

### DIMENSIONS FOR COLUMNS THAT WRAP AROUND POSTS

Column Diameter	6"	8"	10"	12"	15"	18"	24"	4" Sq.	6" Sq.	8" Sq.	10" Sq.	12" Sq.
Existing Post Max. Circum.	14"	20"	25"	30"	40"	45"	55"	10"	16"	22"	25"	30"

## Aluminum column styles.

All components of our columns are manufactured in the U.S. to ensure the highest standard of quality and reliable source of supply. Arndt & Herman offers a wide selection of styles, sizes and colors of columns pilasters, half columns, capitals and bases.



## Fiberglass columns.

- Load bearing
- Will not rot, bow or crack
- Substantially more impact resistant than wood
- Decorative Capitals available
- Tapered in the Greek tradition
- Quick and easy to install
- Full selection of round and square columns.



## Aluminum columns are perfect for residential and commercial applications.

- Load bearing—Capacities up to 30,000 lbs
- Easy installation
- Designed to wrap around existing posts if desired
- The aesthetics of wood and the durability of aluminum
- Premium powder coat finish—Resists aging, weathering and chalking
- Strong Construction—Made from strong 6063 aluminum alloy extrusions
- No rotting, cracking, insect infestation
- Column selection that allows traditional and contemporary designs
- System assembly creates a seamless appearance
- Lengths from 8 to 20 feet
- Mix and match choices of capitals and bases
- Pilasters and half-columns available
- Ideal for porch posts, carports, and decks

## Aluminum column assembly and installation is easy.

**Step 1:** Measure the porch opening and cut each column 1/16 of an inch longer than required. Be sure to wear appropriate safety equipment when cutting.



**Step 2:** Secure the ceiling with a jack and remove old column, if necessary.

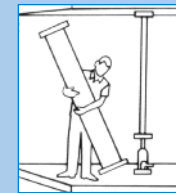

**Step 3:** Snap column staves together.

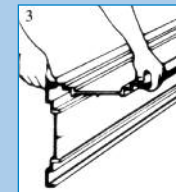

**Step 4:** Slip on capitals and bases.



**Step 5:** Raise column into place and lower jack.



**Arndt & Herman**  
BUILDING PRODUCTS®

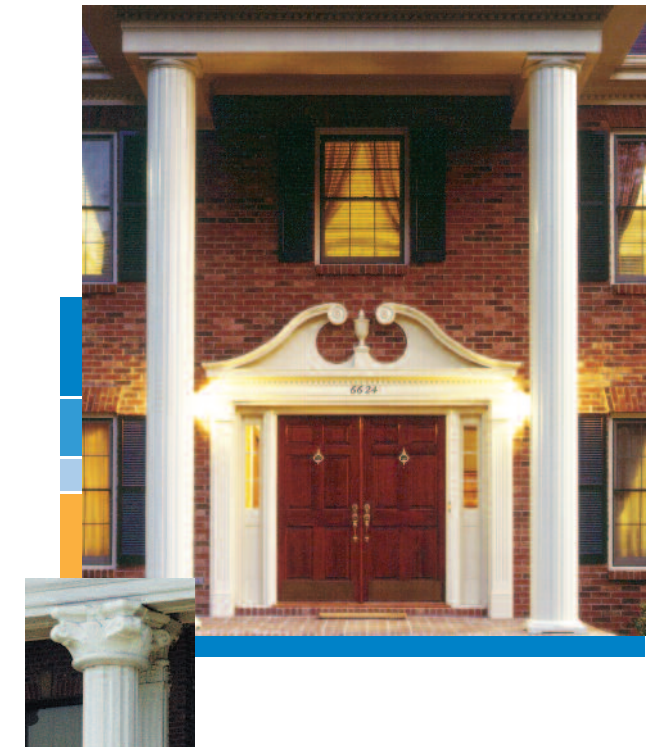

## Aluminum Columns

SOLUTIONS

- Load bearing
- Easy installation
- Premium powder coat finish
- Lasts longer than wood
- Residential and commercial applications

**ECMD**  
Design  
Craftsmanship  
For more information,  
contact 1-866-204-3139 or  
visit [www.arndtandherman.com](http://www.arndtandherman.com)  
Prices and products subject to change

**Arndt & Herman**  
BUILDING PRODUCTS®