

# AHBP Series 3000 Top Rail

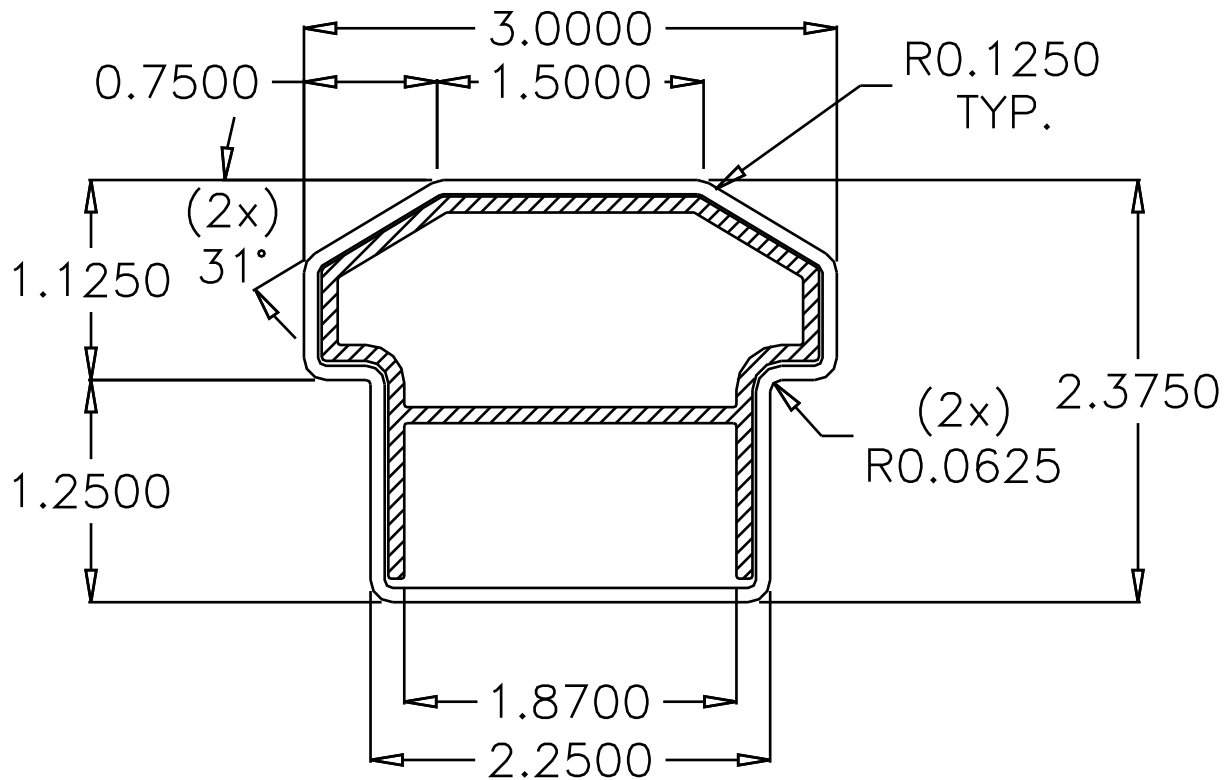

**PVC PROFILE**  
Wall Thickness 0.080 in

**ALUMINUM PROFILE**  
Wall Thickness 0.090 in

Cross-Sectional Area  
0.765 in<sup>2</sup>

Cross-Sectional Area  
0.793 in<sup>2</sup>

Moments of Inertia  
X: 0.595 in<sup>4</sup>  
Y: 0.771 in<sup>4</sup>

Moments of Inertia  
X: 0.296 in<sup>4</sup>  
Y: 0.667 in<sup>4</sup>

**DESCRIPTION:** AHBP Series 3000 Top Rail w/ Aluminum Rein.

**REVISION:** 0 **DATE:**

**TOLERANCE:** N/A

**DRAWN BY:** JJK **DATE:** 11/16/04

**SHEET:** 1 OF 1

**MANUFACTURING APP.:** TM **DATE:**

**FILE NAME:** AHBP Series 3000 Top Rail

**MARKETING APP.:** BA/JS **DATE:**

**SCALE:** FULL